

MITEK® Z4 TIE-DOWN SYSTEM INSTALLATION

MiTek® Z4 Tie-Down System Components

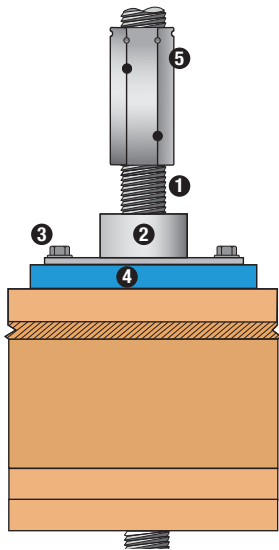

1
THREADED ROD

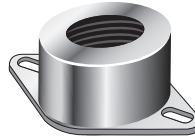

2
CINCH NUT (CNX)



3
WS3 MITEK® PRO-SERIES™ SCREWS

MiTek® PRO SERIES™

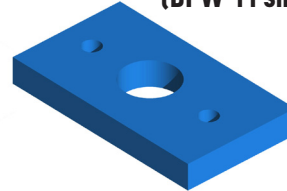

4
BEARING PLATE WASHER (BPW-11 shown)



5
COUPLER

Standard Grade

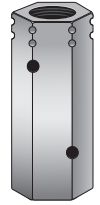

High Strength Reducer

Installation Steps

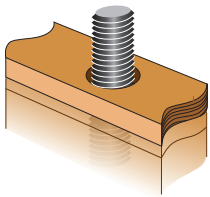

Step 1. Drill hole 1/2" larger than the threaded rod diameter then insert rod.

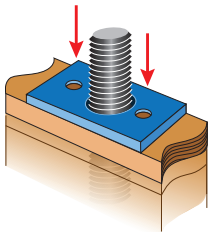

Step 2. Slide the Bearing Plate Washer over the threaded rod then push down until fully seated onto the wood framing.

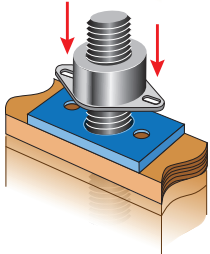

Step 3. Slide the Cinch Nut evenly down the threaded rod until fully seated onto the Bearing Plate Washer.

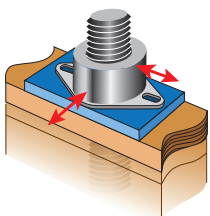

Step 4. Do not install the MiTek® Pro Series™ Screws until:

- Rod is in tolerance for plumb and not in contact with wood framing below
- CNX is centered on rod
- CNX is fully seated on BPW

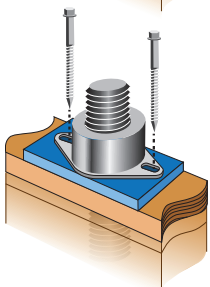

Step 5. Install MiTek® Pro Series™ screws as shown.

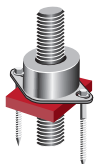

Install MiTek® Pro Series™ screws outside of models BPW5 and BPW6*.

* Ensure CNX is level and screws are not over-driven.

IMPORTANT: Drill hole 1/2" larger than the threaded rod diameter. Ensure rod offset is no more than 2" for each 100" height (2%).

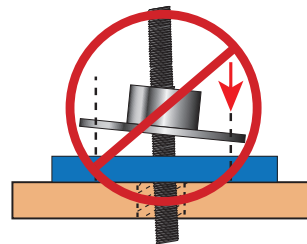

INCORRECT - Over-sized hole, rod exceeds tolerance for plumb.

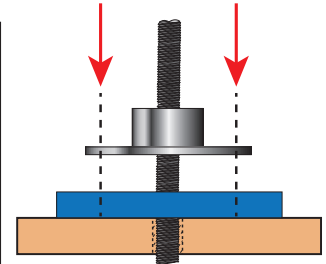

CORRECT - Hole drilled 1/2" larger than rod diameter and equal pressure is applied to fully seat CNX on the BPW.

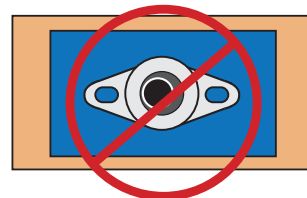

INCORRECT - Rod, CNX, BPW hole, and wood framing hole not centered.

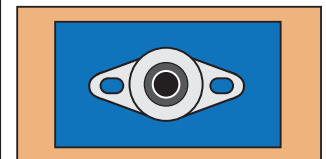

CORRECT - Rod, CNX, BPW hole, and wood framing hole aligned and centered.

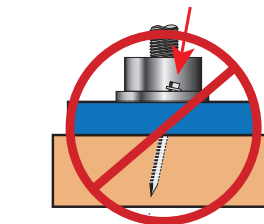

INCORRECT - screw installed at an angle.

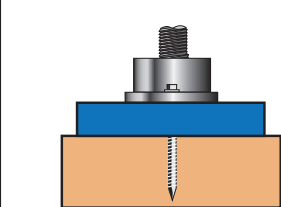

CORRECT - screw installed plumb.

MiTek®

1-800-268-3434