

SERVICE BULLETIN #140a December 9,1996

-Engineering Department-

In order to keep the Lumber Stop rack an equal distance from the proximity switch we are sending a tab, setscrews and jam nuts to all **MiTek® Cyber Saw®** Owners.

Please weld the tab onto the Lumber Stop as per figure below and attached drawing.

Materials Needed:

- (1) Lumber Stop Mtg Tab
MiTek® P.N. B79814
- (1) SCREW-SET
SKTHDDOG 5/16-18x1"
MiTek® P.N. 334685
- (1) NUT-JAM 5/16-18
MiTek® P.N. 361653

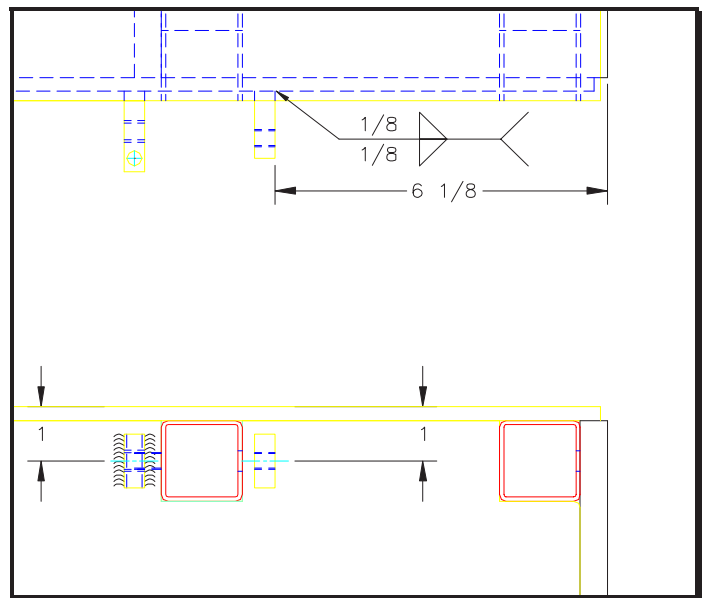

Attached is a revised print of the Lumber Stop Weldment and Lumber Stop Assembly showing above update.

Please replace the prints in your manual.

The following customers received the Lumber Stop Tab. All other machines were manufactured with this feature in place.

- AC Houston Lumber Company SOO3991
- Chambers Truss SOO3996
- MiTek Industries S.A. SOO5146
- Gang-Nail Australia Ltd SOO5091
- Gang-Nail Systems A B S004187
- MiTek Industries Ltd S007056
- Superior Truss And Components SOO7010
- Perfection Truss SOO7231
- Gang-Nail SOO5645

The following drawings should be included with this Service Bulletin:

77082D

77435C